

Configuration		
Dash #	Model #	Lighting
-09	MD40-09	Omit
-09L	MD40-09L	

Revisions				
ECO	Rev.	Description	Date	Approved
1337	A	Update to new title block. Revise dwg. Add notes and config. table. P/N was 2010056-09. Title was MD40-09(L) Installation Diagram	9/20/99	JBR

Logo and company name have been changed in title block only. No functional or technical changes have been made. Revision remains unchanged.

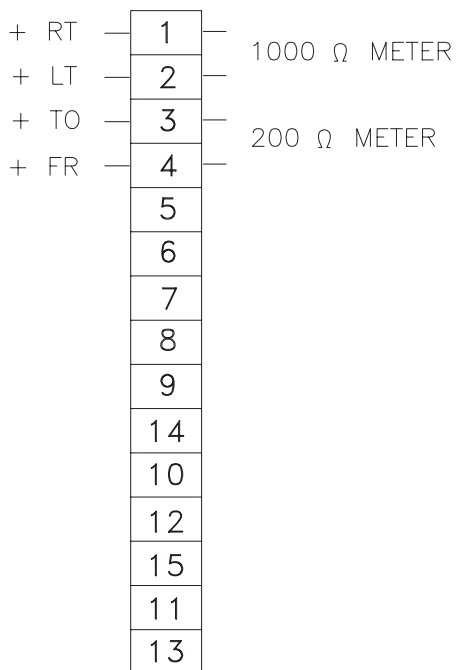

DE-15P connector on CDI mates with DE-15S

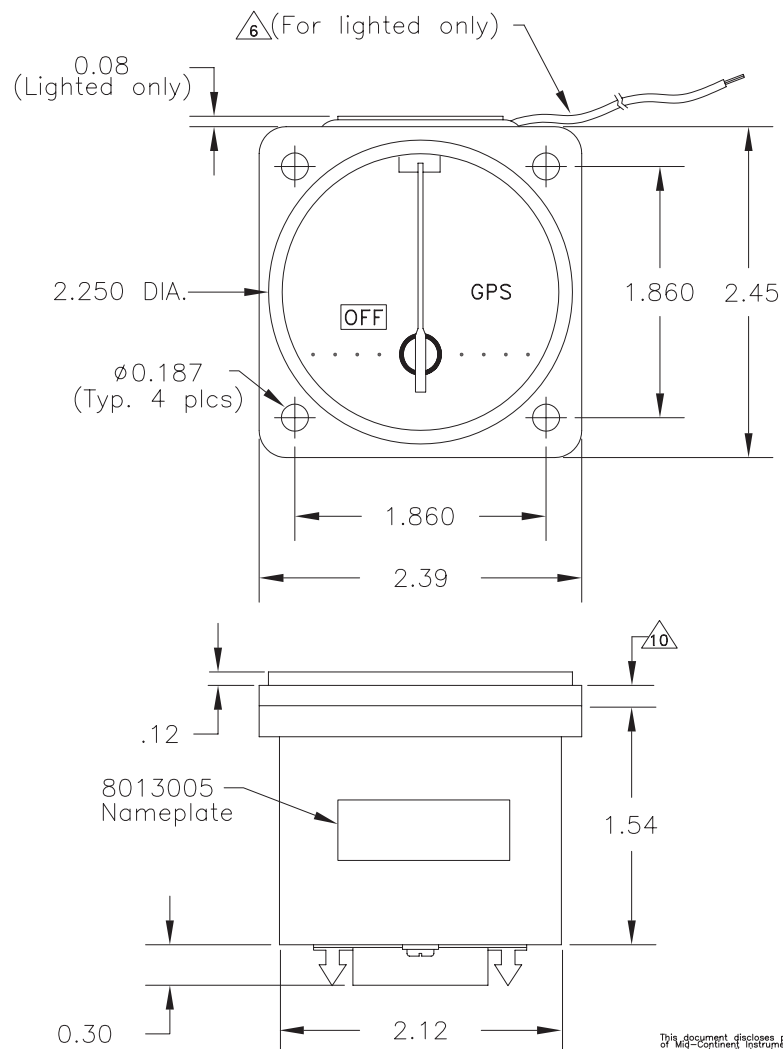

NOTE:

- 1) Conform to TSO C60a
- 2) Environmental testing requirement, DO-160B Catagories (F2-BA(MN)XXXXXXZ)
- 3) Functional test per test data sheet for particular P/N.
- 4) Case is dull black
- 5) Bezel is dull black or gray per customer spec.
- 6) Light Tray (5V, 14V or 28V) per customer spec.
- 7) The weight shall be 0.5 lb max
- 8) Dial marking shall be matte white (FED-STD-595, #37875) on a flat black background (#37038)
- 9) Indicating portion of pointer shall be matte white
- 10) Lighted unit: Bezel thickness is 0.313  
 Non-lighted unit: Bezel thickness is 0.170

UNLESS OTHERWISE SPECIFIED  
 ALL DIMENSIONS ARE IN INCHES  
 TOLERANCE: FRACTIONAL = ±1/64  
 .XX = ±.020  
 .XXX = ±.010  
 .XXXX = ±.002  
 ANGULAR = ±0.5°  
 CONCENTRICITY: .005 TIR  
 BREAK ALL SHARP EDGES  
 THREADS PER MIL-S-7742

DRAWN	S. Hoang	2/25/93
APPROVED	Bill Barnes	3/29/97
TOP LEVEL ASSY:	8018558-09L	8018566-09
USED ON		
END ITEM:		
CODE IDENT. NO.: 59742		

		TITLE: Course Deviation Indicator (CDI)		PART NUMBER: 2010056-09, -09L	
		SCALE: None	DO NOT SCALE THIS DRAWING		SHEET 1 of 1

This document discloses proprietary information of Mid-Continent Instrument Co., Inc. and is not to be reproduced or disclosed in any form without the written permission of Mid-Continent Instrument Co., Inc. and is not to be used in any way detrimental to the interests of Mid-Continent Instrument Co., Inc.